

BUILT ENVIRONMENT



# HIGHER CERTIFICATE IN INTERIOR DECORATING



INSCAPE



## COURSE INTRODUCTION

The Higher Certificate in Interior Decorating educates students on how to enhance interior spaces. **Students develop design skills to create functional and meaningful environments.** Students apply **interior decorating, design, technology and materials knowledge to develop innovative design solutions.** This programme teaches students how to design captivating **spaces with a client's personal style in mind.** The Higher Certificate equips graduates **with practical knowledge and skills for entry into the job market,** with an emphasis on **work-integrated learning to prepare them for the professional world.**

The qualification can be completed as a **one-year full-time contact programme or via distance learning with flexible options (1-year min and 2-year max).** Graduates **may progress to a Diploma or Degree in Interior Design or another relevant design field.** Students pursuing further education must **meet institutional entrance requirements.**

## COURSE OVERVIEW

- This practical, industry aligned programme equips students with the creative, technical, and business skills needed to thrive in the interior decorating industry.
- Students develop essential hand and digital drawing skills, along with a strong foundation in the theory, process, and principles of interior decorating.
- The course introduces spatial planning, surface treatments, colour theory, lighting, and materials, with a focus on real-world application and sustainable choices.
- Learners explore modern tools including AI, SketchUp, Homestyler, and Canva to visualise, style, and present professional interior schemes.
- Business modules include project and professional practice management, supplier relations, and how to start and run your own decorating business.
- Readiness modules help students prepare for life beyond the classroom – developing confidence, critical thinking, and the soft skills needed to thrive in work, society, and real-world challenges.
- Work-Integrated Learning (WIL) modules equip students for the professional world through CV preparation, interview practice, and real-world simulations that build career confidence and industry insight.



# FOCUS AREAS

- Decorating Fundamentals, Colour theory & Styling
- Visual Presentation & 3D Visualisation
- Surface Treatments & Lighting Design
- Industry Practice & Starting and Running Your Decorating Business
- Spatial Planning & Technical Considerations
- Smart technologies, Sustainable & Future-Focused Interiors
- User focused Interior Solutions



GROUND FLOOR PLAN

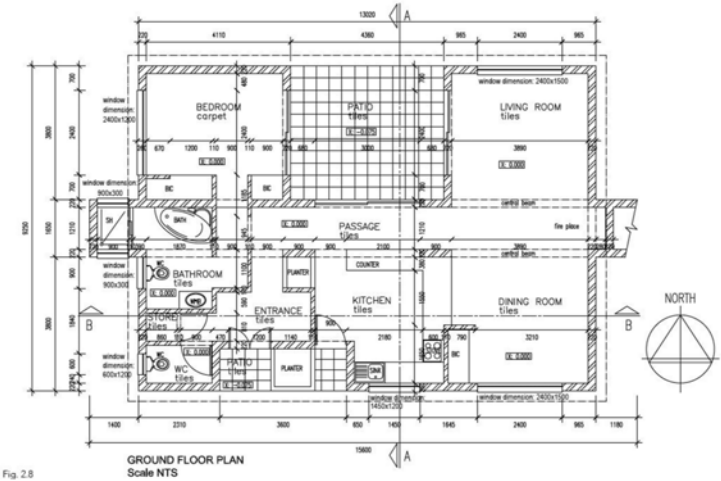

AERIAL VIEW

# SUBJECTS

- Decorating Foundations
- Decorating Practice
- Decorating Tools
- Decorating Industry
- Readiness
- WIL (Work Integrated Learning)



Designers in this field can experience diverse career opportunities in the world of design and aesthetics where your creative flair can shape inspiring and visually captivating spaces.

- Interior Decorator  
(freelance, studio, or retail)
- Styling Consultant
- Visual Merchandiser
- Home Staging Specialist
- Retail Showroom Stylist  
(e.g., furniture or décor store)
- Interior Sales Consultant  
(tiles, wallpaper, soft furnishings, etc.)
- Interior Styling Content Creator
- Interior Decorating Business Owner

Graduates may also work in:

- Décor magazines and online publications
- E-commerce home and lifestyle platforms
- Collaboration with architects, builders, or interior designers
- Boutique guesthouses, hotels, Airbnbs, or event styling teams

**CAREERS**

# COURSE STRUCTURE



## CONTACT LEARNING

- ✓ 1 Year full time
- ✓ NQF Level 5
- ✓ 120 Credits
- ✓ 8 x 1h 45 min sessions per week
- ✓ Approximately 2.5 hours additional independent study per session

## DISTANCE LEARNING

- ✓ Flexible structures available (min 1 year duration)
- ✓ NQF Level 5
- ✓ 120 Credits
- ✓ Enrolments in March, July, and November

## Why Choose Distance Learning with Inscape?

- Subjects are delivered in structured, bite-sized modules for accessible online learning.
- All courseware and assignments are provided through the Inscape LMS.
- Flexible study options are available – complete the programme at a pace that suits your lifestyle and personal circumstances.
- Multiple enrolment opportunities throughout the year to fit your schedule.
- Study from anywhere, at your own pace, with live online sessions for support and connection.
- Dedicated assistance for technical, academic, administrative, and financial queries.

## ARTICULATION OPTIONS

Students who have graduated with the Higher Certificate in Interior Decorating may apply for the Degree at Inscape if they have an average of over 60%, or for a Diploma if they have passed with an average over 50%. Graduates may qualify for Diploma or Degree in a related Design field. Institutional minimum requirements will apply.



SAQA ID: 94798 | NQF 5  
**CONTACT LEARNING : 1 YEAR**  
**DISTANCE LEARNING: FLEXIBLE OPTIONS (1-YEAR MINIMUM, 2-YEAR MAXIMUM)**





## ENTRY REQUIREMENTS

South Africa	Special Admissions	International Qualifications
<p>To be able to gain access to the Higher Certificate in Interior Decorating applicants should be in possession of: National Senior Certificate (NSC).</p> <p>Or</p> <p>Senior Certificate.</p> <p>Or</p> <p>National Vocational Certificate NC(V) at NQF Level 4.</p> <p>If you have any queries regarding the process, please email - <a href="mailto:applications@inscape.co.za">applications@inscape.co.za</a></p>	<p><b>Mature age exemption</b> Candidates over the age of 45 who did not complete Matric may qualify for mature age exemption.</p> <p>Please contact the Registrar for additional information <a href="mailto:registrar@inscape.co.za">registrar@inscape.co.za</a></p> <p><b>RPL</b> If the candidate has a NQF level 3 qualification, but has design industry experience, they may qualify for entry via Recognition of Prior Learning (RPL).</p> <p>In order to be considered for entry via RPL the candidate should have a minimum of two years industry experience.</p> <p>The RPL process is used to evaluate the learning that candidates with existing industry experience may have gained and would need to be substantiated with relevant supporting documents.</p> <p>Please contact the Registrar for additional information <a href="mailto:registrar@inscape.co.za">registrar@inscape.co.za</a></p>	<p>If the candidate has a foreign qualification, for admissions to a Higher Certificate, they must apply to South African Qualifications Authority (SAQA) for a National Senior Certificate NQF level 4 equivalence.</p> <p>International candidates must be competent in English at and equivalent level to NQF 4.</p> <p>All international students attending contact classes require a study permit in the name of Inscape Education Group valid for the duration of the chosen course.</p> <p>Please contact the Registrar for additional information <a href="mailto:registrar@inscape.co.za">registrar@inscape.co.za</a></p>



# LEARNING HUBS



## CAPE TOWN

5th Floor, 9 Somerset Road, De Waterkant  
Centre, DE WATERKANT



## DURBAN

Liberty Building, 4 Park Lane, Umhlanga  
Ridge, UMHLANGA



## MIDRAND

353 Alexandra Road, HALFWAY GARDENS



## PRETORIA

193 Corobay Avenue, WATERKLOOF GLEN



## STELLENBOSCH

Bosman's Business Centre, 1 Distillery Road,  
Stellenbosch Central, STELLENBOSCH

## APPLICATIONS

Phone (+27) 861 467 2273  
Fax: (+27) 86 409 1627  
[applications@inscape.co.za](mailto:applications@inscape.co.za)

## CENTRAL

PostNet Suite 104, Private Bag X19,  
Menlo Park, 0102, SOUTH AFRICA

**INSCAPE**  
APPLY NOW | [INSCAPE.AC](https://www.inscape.ac)

### REGISTRATION AND ACCREDITATION

Inscape Education Group (Pty) Ltd is registered with the Department of Higher Education and training as a Private Higher Education Institution under the Higher Education Act, 1997 (reg no. 2000/HE07/002). Established in 1981. Company Reg: 2002/028979/07. VAT Reg: not applicable. Directors: HL Bührs and ME Schoeman.